



Welcome home to Hanley Crossings
... Take advantage of our exceptional location. Just seconds from Highway 70 and I-170 with the "Hanley Metro Link Station" across the street. You will find easy access to Lambert International Airport, Northwest Plaza, Christian Hospitals and minutes to downtown St. Louis or downtown St. Charles.

Our spacious one and two bedroom apartments will exceed your expectations.

FEATURES:

- Wall to Wall Carpeting
- Large Closets
- Patios or Oversized Balconies
- Oak Cabinetry in Kitchens
- Marble Sinktop with Oak Vanity Cabinets in Baths
- Dishwasher
- Frost-Free Refrigerator
- Electric Range and Range Hood
- Gas Heat and Central Air Conditioning
- Double Pane Insulated Windows and Sliding Doors
- On-Site Laundry Facilities
- Mini Blinds
- Cable TV available
- 2 Playgrounds

Our friendly on-site management team will help you feel right at home.

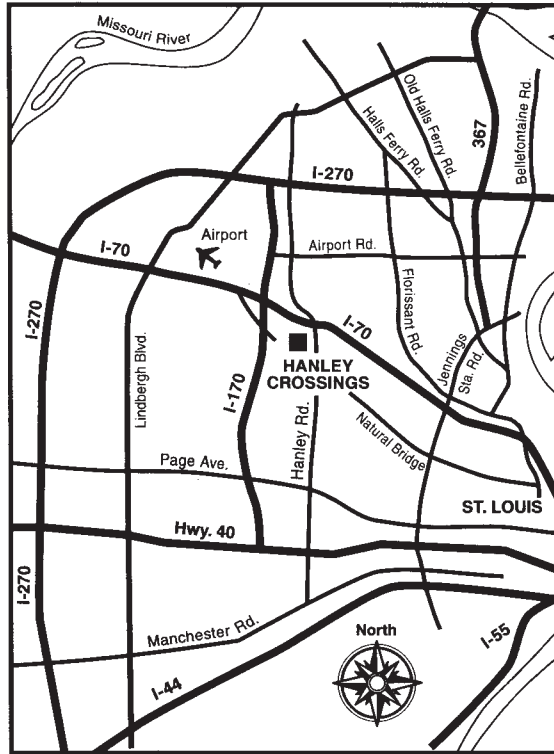

**8806 DRAGONWYCK DRIVE
ST. LOUIS, MO 63121**

(314) 426-7667

FAX: (314) 426-7368

E-MAIL:

hanleycrossings@gundakercommercial.com

GUNDAKER
COMMERCIAL GROUP



Welcome!

*Hanley
Crossings*

**8806 DRAGONWYCK DRIVE
ST. LOUIS, MO 63121**

(314) 426-7667



ONE BEDROOM FLOOR PLAN:

Rent _____

Deposit _____

TWO BEDROOM FLOOR PLAN:

Rent _____

Deposit _____

Agent Name

8806 DRAGONWYCK DRIVE
ST. LOUIS, MO 63121
(314) 426-7667
FAX (314) 426-7368

ONE BEDROOM *Approximately 600 Square Ft.*

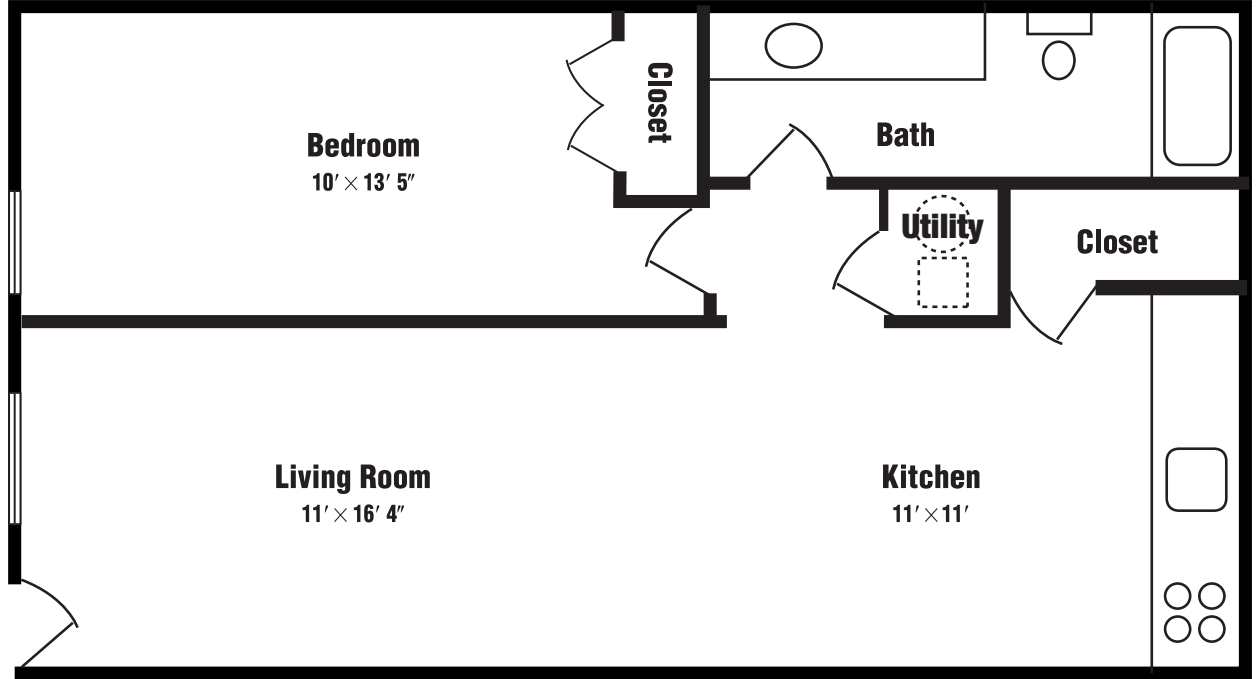

TWO BEDROOM *Approximately 700 Square Ft.*

